

Summer 1987 Loggerhead Shrike Nest Locations

Highway and Transportation Map ADAIR COUNTY IOWA

Prepared By
Iowa Department of Transportation
Phone (319) 339-1289
In Cooperation With
United States Department of Transportation



- = nest locations
- = nest built - no nesting attempted
- ⊗ = shrike sightings
- ⊗ = possible nest (young in area)

5/19 - rained all night
5/21 - "
5/22 - very cold 30s during night
5/26 - "
5/26-5/29 showers occurred throughout week usually w/lt or mly
6/2 - "

LEGEND

CONTOUR LINE	...
SECTION LINE	...
UNIMPAVED ROAD	...
PAVED ROAD	...
RAILROAD	...
...	...

LEGEND

...	...
...	...
...	...
...	...
...	...

Dr. Dinsmore,
I thought you might be interested in knowing the locations of the shrike nests. These maps include nests monitored along with several others that were not. Two other nests located in Adams and Union counties are not included here.
Dave DeSousa

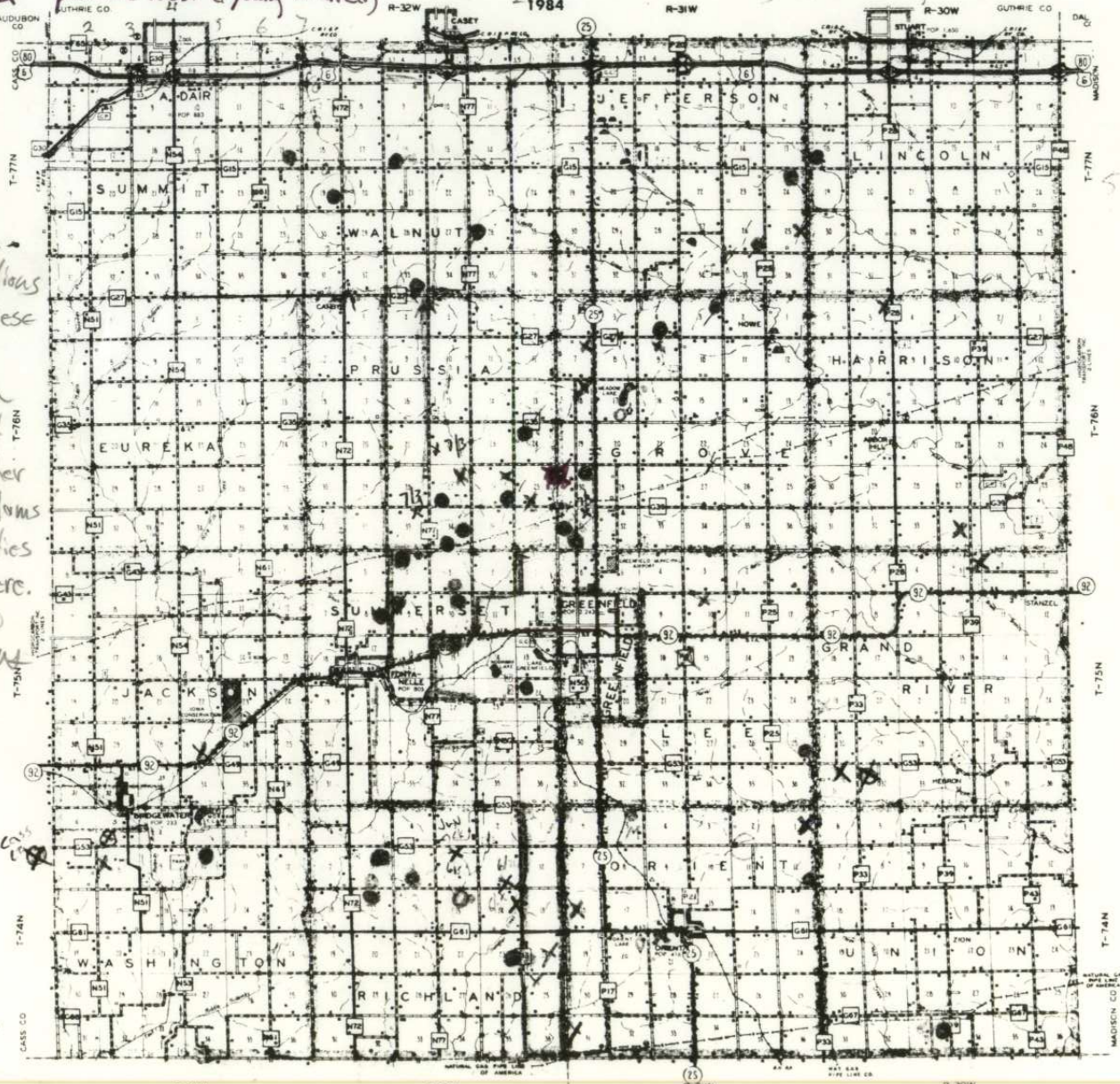

24
5
2nd

- 5
- E
- 7
- 8

7
15
22



LEGEND

STATE LINE
COUNTY LINE
CIVIL TOWNSHIP LINE
SECTION LINE
UNIMPAVED STREAM
SPRING
RAILROAD STATION
RAILROAD BELT (OVERHEAD)
RAILROAD HOME (UNDER)
RAILROAD SINGLE TRACK (OVER)
CENTER OF CITIES
CENTER OF COUNTY SEAT
RAILROAD CROSSING
ROADWAY
BEARING AREA (OVERLAP)
UNIMPAVED ROAD (DASH)
GRADED AND GRAVEL ROAD
PAVED ROAD
LEGAL ROAD NOT OPEN TO TRAFFIC
ROADWAY WITH SPECIAL CONTROL OF ACCESS
UNIMPAVED SURFACED ROAD
AIRPORT, LIMITED FACILITIES
LANDING AREA OR STRIP
BUILDING OR PUMPING STATION

Highway and Transportation Map RINGGOLD COUNTY IOWA

Prepared By
Iowa Department of Transportation
Phone (515) 281-1200
In Cooperation With
United States Department of Transportation

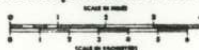

1984

LEGEND

PAVED HIGHWAY
UNPAVED HIGHWAY
TRAILHEAD OR COUNTRY HALL
STONE OR BRICK BUSINESS ESTABLISHMENT
WOOD SHED
SCHOOLHOUSE OR OTHER EDUCATIONAL INSTITUTION
CHURCH OR OTHER RELIGIOUS INSTITUTION
HIGHWAY GARAGE
REST ROOM
SELF-SERVICE OR COUNTRY CLUB
COUNTY HALL
ROAD GARAGE
UNITED STATES DEPT.
STATE HIGHWAY SYSTEM
COUNTY TRAIL SYSTEM
FEDERAL AIR ROUTE SYSTEM
POINTS BETWEEN WHICH DISTANCES ARE MEASURED
END OF FEDERAL AIR DESIGNATED ROUTE
RAILROAD STATION
CAMP OR LODGE
RECREATION BUILDING
GARAGE OR RUBBER SHOP
CONCRETE DRIVEWAY AND DRIVE
PAVING/ROADS, RACE COURSE
WATERGATE
LAND FARM
AUTO JUMP START
SANITARY LAND FILL
SMALL PARK (COUNTY) STATE
UNION CO.

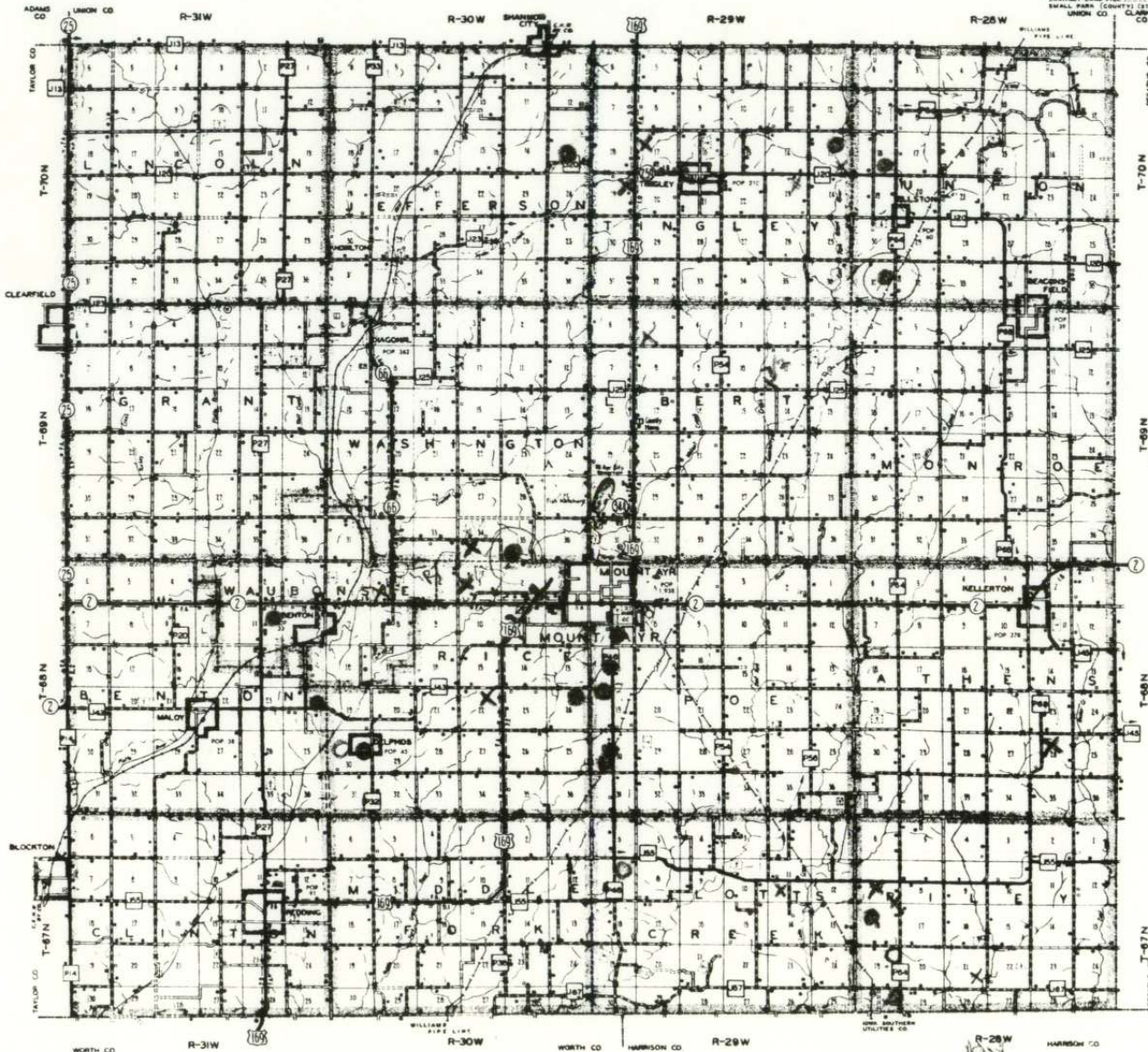

Summer 1987
Shrike Nest
Locations

15 nests



SEC 1, T47N, R25W
JULY 1984
REVISION 1

4 mi W
Collection - 2/1/88

