

*Inclosure # 5*

T

Mrs. F. M. Braley  
209 West Thomas Avenue  
Shenandoah, Iowa, 51601

Route 3, Box 75  
Red Oak, Iowa, 51566  
January 17, 1969

Dear Mrs. Braley:

I have been very disappointed in having not heard from you... maybe I misunderstood you, but I thought you or someone from your Audubon Club were coming by the 30th of December; maybe you meant 30th of January? Do you think that you soon can come?

I would like very much to have Mrs. DeLong come this spring or any time and trap birds in nets and band on our "Frank Forty". Do you think that this would be at all possible? I would be happy to assist her, or if she preferred to work alone, that would be fine with me also.

I think, since I talked to you, to my bird list this winter (on our Forty) I have added the brown creeper and golden-crowned kinglet. I still am unable to identify those other birds down in the fen and spring; I would appreciate very much help in identifying these birds. They might be a winter bird and migrate north this spring. In the spring there will be owls that probably will return that I am unable to identify. We hope the whip-poor-will will return.

So far this winter my husband has made a cocconut suet feeder, a wooden suet feeder, swinging wooden seed feeder and a blue bird house; so we are getting in gear.

There is a long list of bushes and trees planned for planting this spring and maybe some annuals.

This morning we spent a half hour from inside the house watching ten deer.

Hoping to see you and Mrs. DeLong soon.

Sincerely yours,

Mrs. George (Dorothy) Franek

P.S. From Coburg Corner on #48 you drive 1 mile north, ~~1/2~~ 1/2 mile west on gravel road, house on north side of road, is where we live.

WRITE @  
COLUMN

1	2	3	4	5	6	7
1 Franek Forty - Oak-Hickory-Walnut Forest and Meadow						
2 Location: From Red Oak, Iowa, Five Miles South on Hi-way #48 and 1/2 Mile West, on North						
3 Side of Gravel Road (SE Qt of SW Qt of Sect 20, 71-38) Grant Township, Montgomery County						
4						
5						
6 Size: 40 Acres (square, - compiled from Montgomery County Plat Book)						
7 25 acres wood, 12 acres meadow and 3 acres lots. Timber cut once about 1920's						
8						
9 Description of Area: Typical woodland of southwest Iowa; trees cut 1920's, so tend to grow						
10 in clumps; trees average 60' high and about 8" DHB. No cattle or domestic						
11 animals allowed in since 1967; no domestic animals on meadow, 1968.						
12 <u>T R E E S</u>						
13 <u>Common Name</u> <u>Scientific Name</u> <u>Reference</u>						
14 White Oak                      Quercus alba                      ASC Field Man & "Trees", Golden Nature Guide						
15 Burr Oak                      Quercus macrocarpa                      " " 1963						
16 Shagbark Hickory                      Carya tomentosa                      " " "						
17 Black Walnut                      Juglans nigra                      " " "						
18 Black Cherry                      Prunus serotina                      " " "						
19 Buck Brush                      x ?						
20 Gooseberry                      x ?						
21 Ponderosa                      Pinus ponderosa                      Iowa State Nursery - Ames						
22 Austrian                      Pinus nigra                      " " "						
23 Concolor Fir                      x                      Plumfield Nursery Catalog						
24 White Pine                      x						
25 Blue Spruce                      Picea pungens                      " " "						
26 Norway Spruce (Black)                      Iowa State Nursery - Ames						
27 Lilacs                      Lilac Rothomagensis                      Plant Manager - Mount Arbor Nursery						
28 Cotoneaster                      x Cotoneaster (?)                      " " "						
29 Dwarf Burning Bush                      x Euonymus (?)                      " " "						
30 x <i>would try to get this</i>						
31 <u>Meadow</u>						
32 Alfalfa                      (?)						
33 Clover                      (?) (Pink & yellow)						
34 Edge: To the east - cultivated corn & soy beans						
35 To the south - across road, cultivated hay, beans or corn. in 1968 it was hay.						
36 To the west - extension of timber.						
37 To the north - extension of timber and pasture (full of thistles)						
38 Water: Three springs originating on acreage - the north & middle ones have running water constantly						
39 All three springs run into greek emptying into the Nishnabotna River (East) and thence						
40 into Missouri River.						



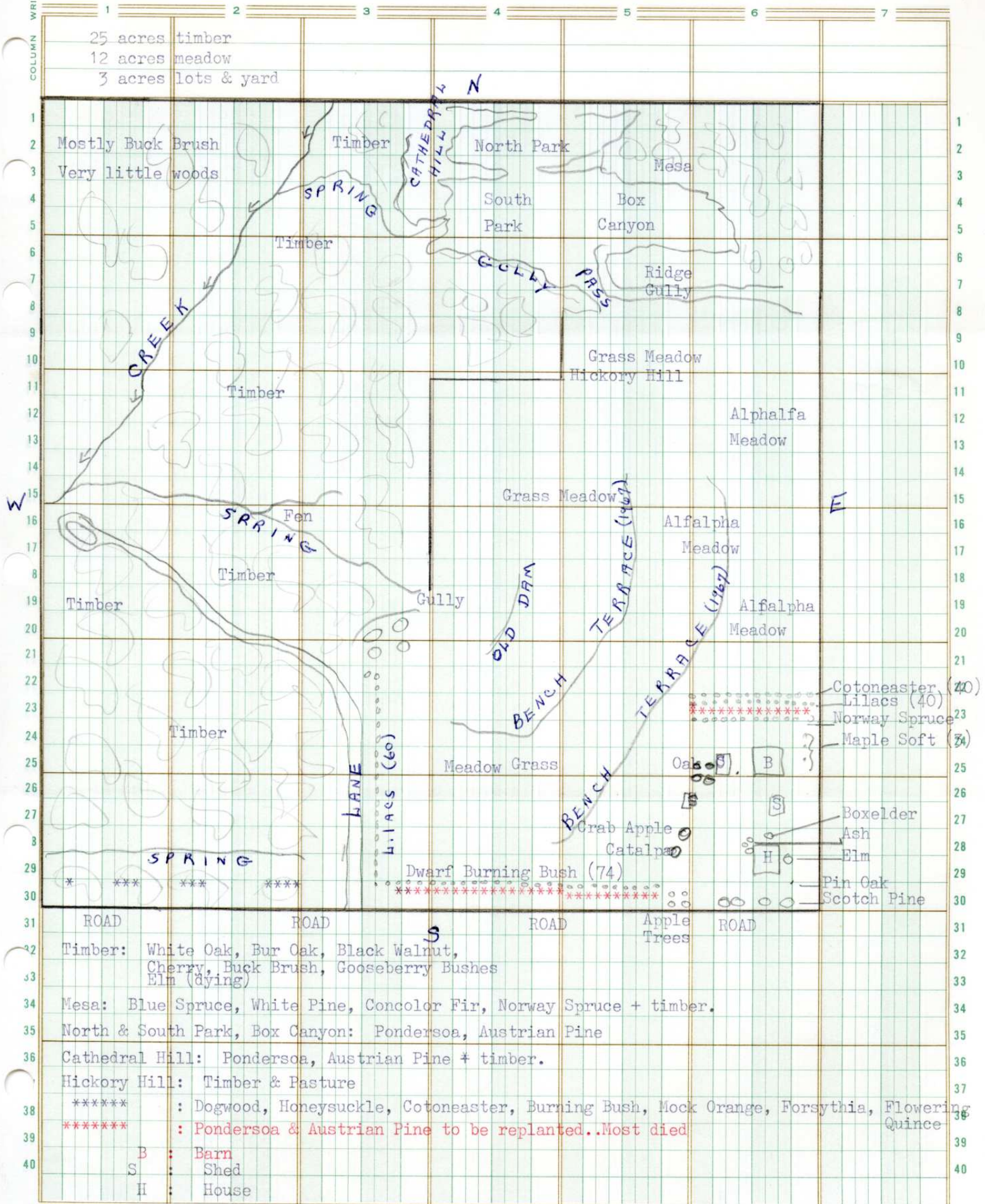

25 acres timber  
 12 acres meadow  
 3 acres lots & yard

Mostly Buck Brush  
 Very little woods

Timber

North Park

Mesa

South Park

Box Canyon

Timber

Ridge Gully

Grass Meadow  
 Hickory Hill

Timber

Alfalfa  
 Meadow

Grass Meadow

Alfalfa  
 Meadow

Fen  
 SPRING

Timber

Gully

Alfalfa  
 Meadow

Timber

Timber

Meadow Grass

Oak

Cotoneaster (40)  
 Lilacs (40)  
 Norway Spruce  
 Maple Soft (74)

Crab Apple  
 Catalpa

Boxelder  
 Ash  
 Elm

SPRING

Dwarf Burning Bush (74)

Pin Oak  
 Scotch Pine

ROAD

ROAD

ROAD

Apple  
 Trees

ROAD

Timber: White Oak, Bur Oak, Black Walnut,  
 Cherry, Buck Brush, Gooseberry Bushes  
 Elm (dying)

Mesa: Blue Spruce, White Pine, Concolor Fir, Norway Spruce + timber.

North & South Park, Box Canyon: Pondersoa, Austrian Pine

Cathedral Hill: Pondersoa, Austrian Pine + timber.

Hickory Hill: Timber & Pasture

\*\*\*\*\* : Dogwood, Honeysuckle, Cotoneaster, Burning Bush, Mock Orange, Forsythia, Flowering Quince

\*\*\*\*\* : Pondersoa & Austrian Pine to be replanted..Most died

B : Barn  
 S : Shed  
 H : House



1	2	3	4	5	6	7
<u>Birds Seen on Acreage</u>						
1	Bobwhite					
2	Ring-Necked Pheasant					
3	Heron					
4	Hawk					
5	Mourning Dove					
6	Rock Dove or Pigeon					
7	Owl (More than one species, I think)					
8	Whip-Poor-Will					
9	Night-Hawk					
10	Hummingbird					
11	Belted Kingfisher					
12	Ladder-backed Red-bellied Woodpecker					
13	Red-headed Woodpecker					
14	Downy Woodpecker					
15	Eastern Kingbird					
16	Barn Swallow					
17	Blue Jay					
18	Common Crow					
19	Black-Capped Chickadee					
20	Tufted Titmouse					
21	White-Breasted Nuthatch					
22	Red-Breasted Nuthatch					
23	Wren (more than one species)					
24	Brown Thrasher					
25	Robin					
26	Eastern Bluebird					
27	Waxwing					
28	Starling					
29	Yellow Warbler					
30	Myrtle Warbler					
31	Other Warblers					
32	Meadowlark					
33	Bobolink					
34	Blackbird					
35	Brown-Headed Cowbird					
36	Baltimore Oriole					
37	Cardinal					
38	Rose-Breasted Grosbeak					
39	Indigo Bunting					
40	American Goldfinch					
41	Dickcissel					
42	Sparrows (more than one species)					
43	Junco					
44	Ducks					
45	Brown Creeper - Dec 22, 1968					
46	Geese					
47	Golden-Crowned Kinglet - Dec, 1968					
48	Hairy Woodpecker - January 16, 1969 ♀					
49						
50						
51						
52						
53						
54						
55						
56						
57						
58						
59						
60						